

32 Bland Street WOOLLOOMOOLOO, NSW

2 1

## Charming Terrace - Location Lifestyle & Views

Positioned in historic 'Bland Street' close to Harry's Cafe, the Wharf and Garden Island, lies this well presented terrace house. Set over two levels, this character filled terrace offers high ceilings with polished floorboards in all living & bedroom areas.

Two double bedrooms are located upstairs and both receive abundant natural light. A north-facing balcony opens off the main bedroom and features views across Woolloomooloo Bay to Cremorne Point. The second bedroom includes built-ins.

The functional 'galley' kitchen features a skylight and opens to an enclosed courtyard, laundry area and bathroom (with skylight and bathtub).

There is strong local amenity with easy access to award winning restaurants and charming local cafes. Wynyard is a short 15 minute stroll via the Domain, and Potts Point can be reached in 5 minutes.

\$1,265,000

**Type** : Terrace  
**Sold Date** : Friday, 10th January 2020

- Private balcony off master with water/harbo

**Slavko Romic**  
0422683007

**Aleksandar Elic**  
0404061232

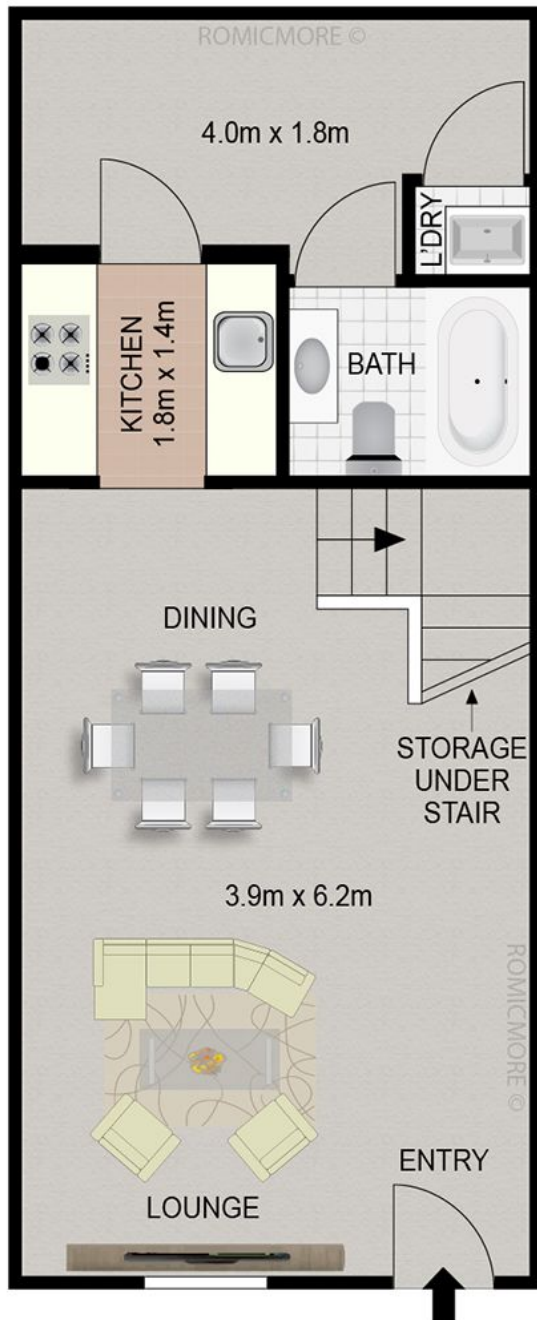

GROUND FLOOR

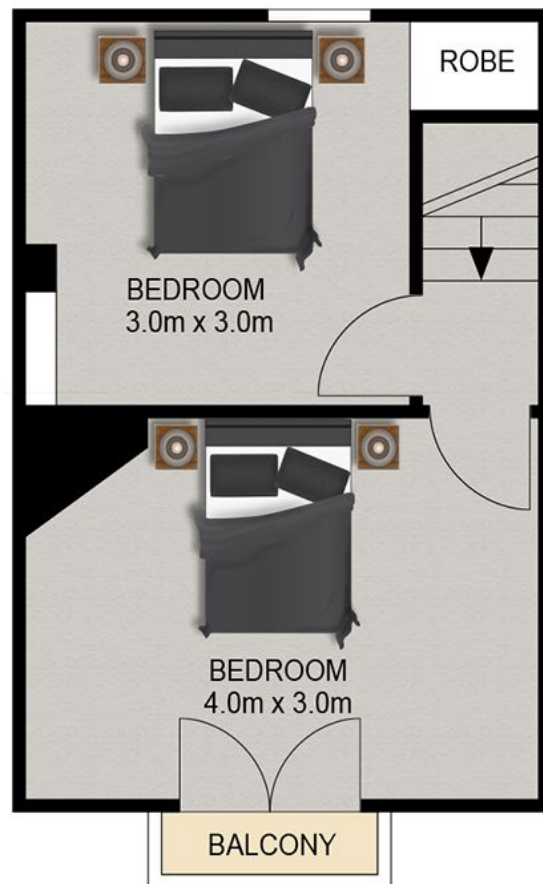

FIRST FLOOR

